

The original Winchester model 70 Trigger



Can be replaced by Timney Model # 401 (Blue) or 401-16 (Nickel Plated)

The new Winchester Model 70 MOA trigger



Can be replaced by Timney Model # 402 (Blue) or 416 (Nickel Plated)

Steps # 1 & 2

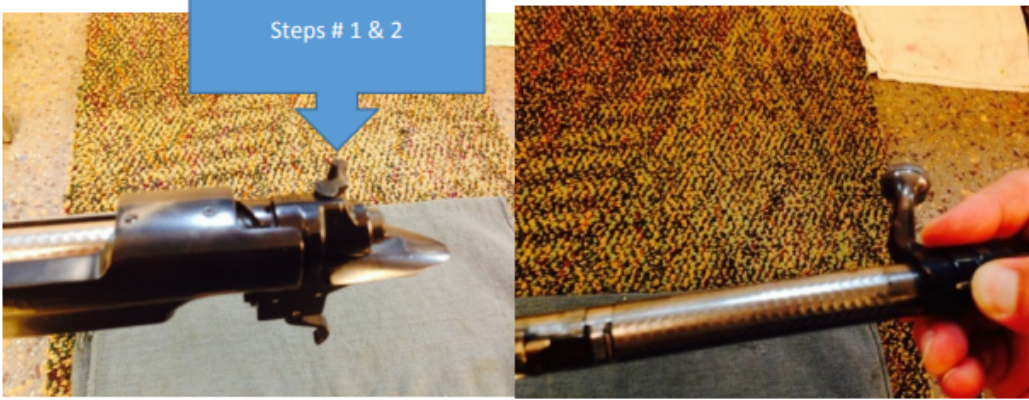

Steps # 3 & 4



Retainer  
and  
Retainer  
washer

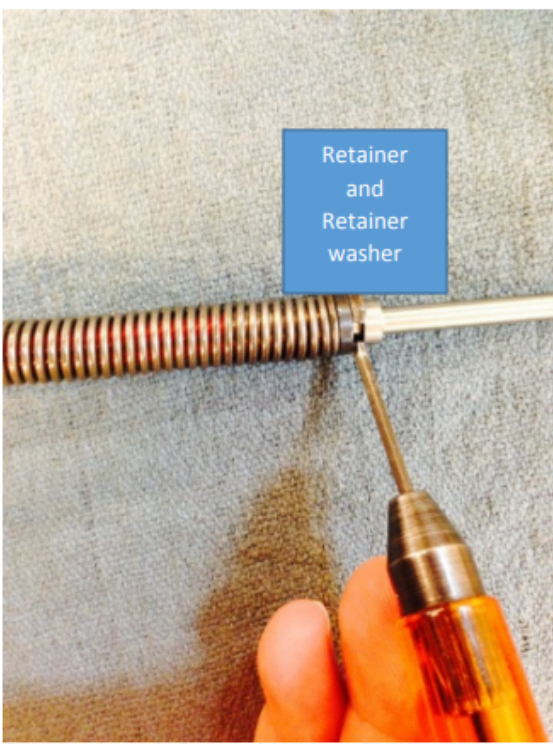

Step # 5



Pliers are between retainer and retainer washer, so that retainer can be removed.



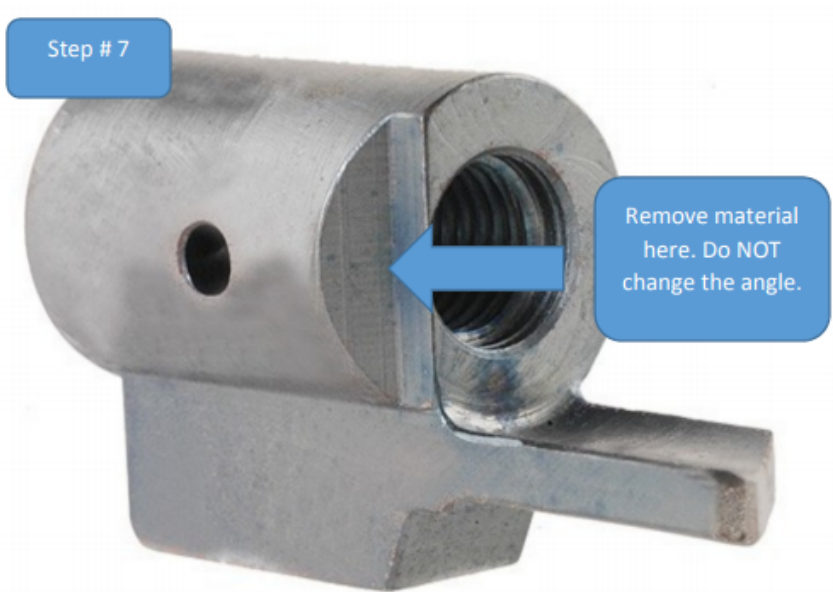
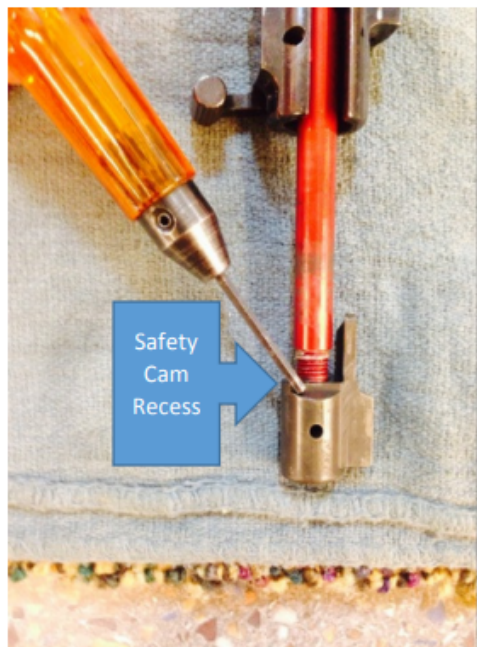
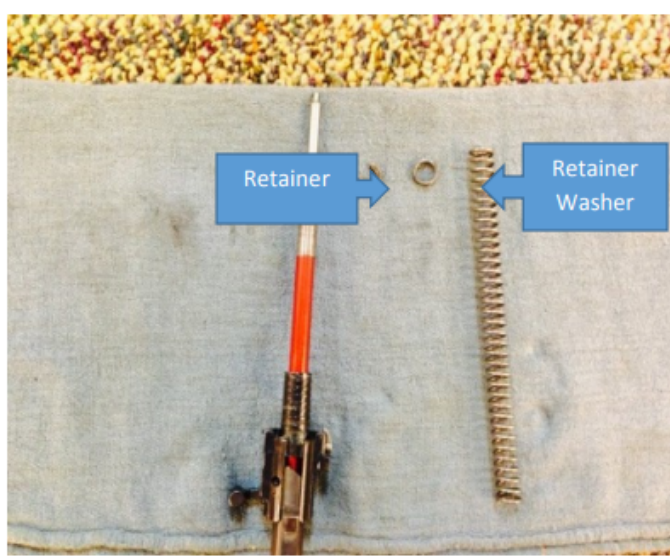

Step # 1: Cock the bolt.  
 Step # 2: Put rifle on half or intermediate safety (position # 1). It may be necessary to use pliers to pull back the firing pin back enough to engage half safety.  
 Step # 3: Remove bolt from rifle.

Step # 4: Press and hold down the bolt sleeve lock; while unscrewing the bolt body from the firing pin assembly.

Step # 5: Using needle nose pliers compress firing pin spring. Put the pliers between the firing pin retaining washer and the firing pin retainer. Press down on the spring while twisting off the retainer or sliding out the washer depending on the version of your rifle. Slowly remove the spring from the firing pin.

Step # 6: Slide the firing pin and cocking piece from the safety shroud.

Step # 7: Without changing the angle remove a few thousandths of an inch from this area. We recommend using a flat file and reassembling to test frequently. (Every 5-10 thousandths of an inch.



If you look through the window the lower arrow is point in when you engage the safety do the trigger and sear disengage? Mean is the sear lifted off the safety? You should be able to see it in the hole when you pull the safety back onto safe.

If it does not but it is not too difficult to engage the safety than I recommend removing a few thousandths of an inch from the flat on the triggers sear as indicated by the top arrow.

Be careful not to change the angle just to remove a couple of thousandths so that the sear and trigger in the hole do not touch when on safe.

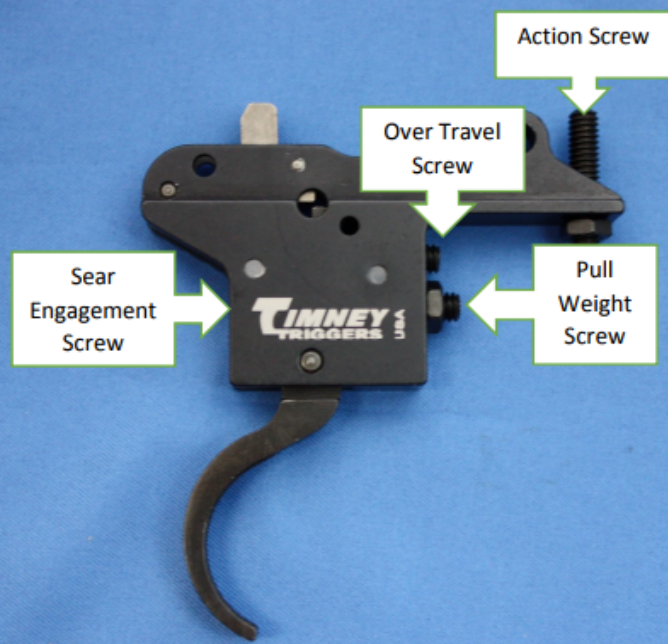

**Adjustment Instructions:**

1. Cock the rifle (make sure it is unloaded).
2. Using a 1/8 Allen Wrench turn the sear engagement screw clockwise slowly until the rifle fires.
3. Turn the sear engagement screw counter clockwise one flat of the wrench.
4. With the rifle in the fired position turn the over travel screw in until it stops and then turn it counter clockwise one flat of the wrench.
5. Pull weight is factory set at 3lbs. to increase pull weight turn the screw clockwise. To decrease the pull weight turn the screw counter clockwise. The pull weight adjustment works by increasing the spring pressure. The spring is behind the screw; as the screw pressure increases on the spring the pull weight increases. BE CAREFUL not to back the screw out too far. Taking the pull weight below 1.5lbs will cause slam fires.

**Tech Guide Downloads**

- [Winchester Model 70 Trigger.pdf](#)
- [Winchester Model 70 Firing Pin Safety Adjustment.pdf](#)
- [Winchester Model 70 adjustment of sear for space.pdf](#)
- [Winchester Model 70 \(401\) Adjustment Instructions.pdf](#)